



- Starting torque adjustable in the range of 180-275%.
- Normal operating slip is 2 to 5% depending on coupling size and starting torque value.
- Suitable for two consecutive starts from hot and three from cold.
- Fusible plug blow off temperature is 130°C standard. Optional:160°C.
- These couplings are radially displaceable.

Rating Table

COUPLING MODEL	KW ratings of couplings at different input speeds (RPM)		
	730 RPM	970 RPM	1470 RPM
T12-			
01	0.6	1.4	5.0
02	0.9	2.1	7.5
03	1.1	2.6	9.3
04	1.8	4.3	15.0
05A	3.3	7.5	27.0
05	4.6	11.0	37.5
06	7.3	17.4	60.0
07	9.8	23.2	80.0
08	19.0	45.0	153.0
08B	28.3	65.0	228.0
09	37.0	90.0	265.0
10A	64.0	150.0	373.0
010	90.0	209.0	485.0
011	148.0	348.0	-
012	260.0	610.0	-
013	500.0	850.0*	-
014	850.0	1000.0*	-

* Coupling for these rating should be selected only after our approval is obtained.

T-12

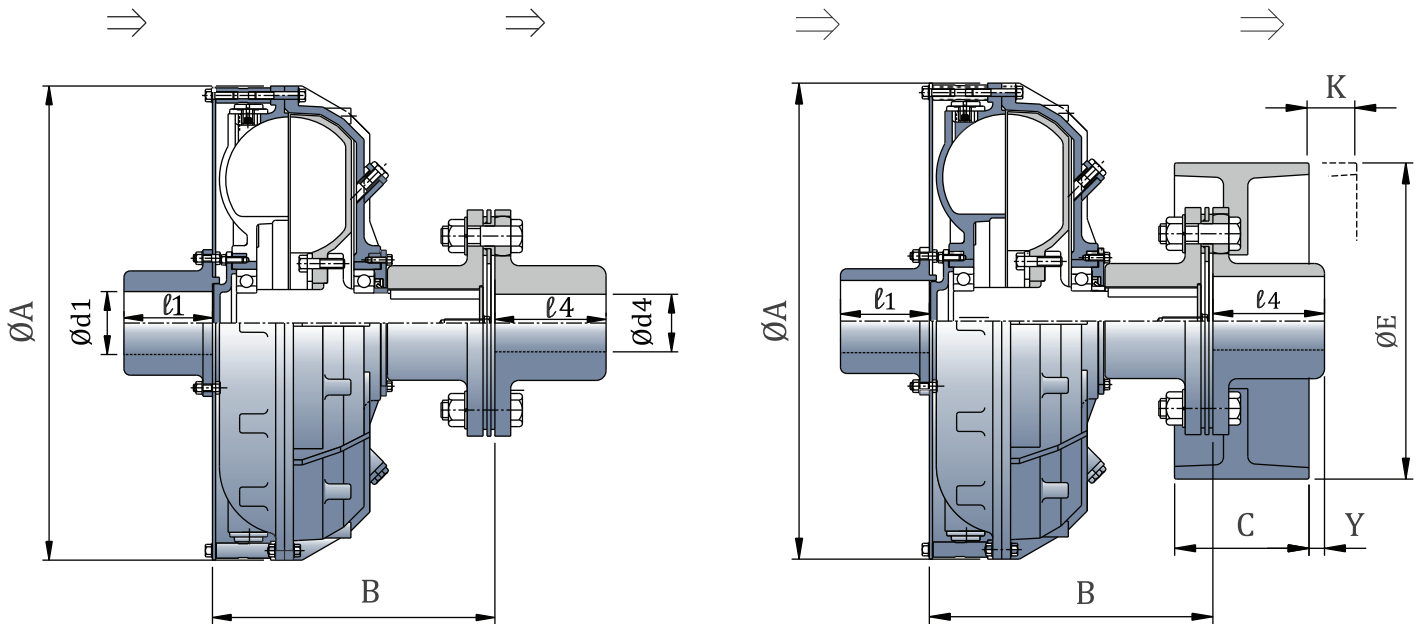

Technical Specification and Dimension Table For T12

Model T-12	A	B	Ø d1 Maximum	l1	Ø d4 Maximum	l4	Dry Weight KG.	Maximum Oil Filling In Litres	Connected Flexible Coupling Model
01	280	167	35	50	55	70	17	1.5	FXC-I
02	310	181	35	50	55	70	20	3	FXC-I
03	330	199	50	80	55	70	26	2.9	FXC-I
04	350	216	50	80	60	70	31	3.7	FXC-II
05A	395	237	50	80	60	70	48	5.1	FXC-II
05	420	276	75	110	75	95	67	5.9	FXC-III A
06	465	290	75	110	75	95	75	8.4	FXC-III A
07	510	314	75	110	90	95	85	11	FXC-III
08	570	347	110	140	90	110	138	15	FXC-III
08B	615	353	110	140	110	125	176	18.6	FXC-IV A
09	650	371	110	140	110	125	183	22.2	FXC-IV A
010A	700	368	110	140	110	125	198	26.3	FXC-IV A
010	750	414	110	140	115	125	234	33	FXC-IV
011	860	488	125	210	145	200	395	50	FXC-V
012	970	568	150	210	145	200	480	75	FXC-V
013	1104	594	150	210	195	200	598	108	FXC-VI
014	1230	655	175	210	195	200	995	160	FXC-VI

Type T12 With Brake Drum

Flexible Coupling Model	Metallic disc Coupling			
	ØE	C	Y	K* Min
FXC-I	160	75	21	26
	200	75	21	26
FXC-II	200	75	19	26
	250	95	10	35
FXC-III	250	95	35	35
	300	118	32	55
	315	118	32	55
FXC-III	250	95	48	35
	300	118	30	55
	315	118	30	55
	400	150	18	73
FXC-III	300	118	52	55
	315	118	52	55
	400	150	40	65
	500	190	05	70
FXC-IV	400	150	40	65
	500	190	05	70
	600	236	(-)31	80
	630	236	(-)31	80
FXC-V	500	190	70	70
	600	236	34	70
	630	236	34	70
	710	265	25	90

*For radial displacement of Fluid Coupling the Brake drum shall need to be shifted by dimension 'K' As shown. The Machine/G.B. shaft length /space should be adequate for this shift of B.D.